



HSV-06

HSV-08

HSV-10

HSV-15

Ordering Code

HSV	01	N
Series	Port Size	Thread Type
Hand sliding series	06: G1/8" 08: G1/4" 10: G3/8" 15: G1/2"	N: Female thread Blank: Male thread

Feature

2/3 Hand sliding valve can be used as switch of Air source. When Air source is switched off, the remained air in system can be released.

Symbol

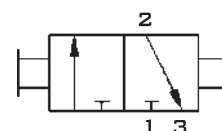

Specification

Model	HSV-06	HSV-08	HSV-10	HSV-15
Port Size	G1/8"	G1/4"	G3/8"	G1/2"
Orifice Size	4mm	7mm	10mm	12mm
Working Medium	Filtered and Compressed Air			
Working Pressure	0~1.0MPa			
Ambient Temperature	-20 ~ 70°C			
Operating Force	20N			

Overall Dimension

Male thread

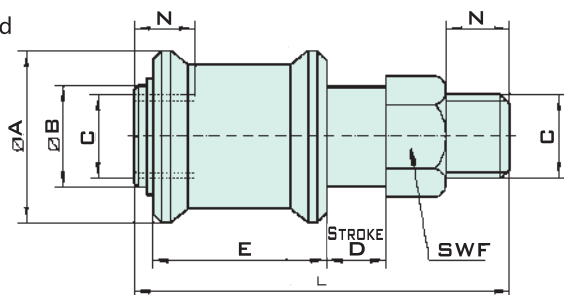

Dimension

Model/ Symbol	A	B	C	D	E	F	N	L
HSV-06	20	13	G1/8	5.5	20	14	6	38
HSV-08	27	18	G1/4	9.5	32	19	10	58
HSV-10	30	21	G3/8	9.5	32	22	10	58
HSV-15	38	24	G1/2	17	40	27	10	80